

843000 AGITATOR ASSEMBLY (for use with 5 gallon container)



**READ THIS MANUAL CAREFULLY BEFORE INSTALLING,
 OPERATING OR SERVICING THIS EQUIPMENT.**

It is the responsibility of the employer to place this information in the hands of the operator. Keep for future reference.

SPECIFICATIONS

Maximum Air Inlet Pressure	100 p.s.i. (6.9 bar)
Horsepower	0.95 hp
R.P.M. Range	300 - 3000
Air Inlet (female)	1/4 - 18 N.P.T.F. - 1
Rotation "set"	Clockwise with propeller
Muffler	Included

PARTS LIST

Item	Description (size)	Qty	Part No.
1	Mixer Motor (includes item 15)	(1)	QMS-428
2	Gasket	(1)	873236
3	End Cap	(1)	QMG-18
4	Adapter	(1)	
5	Set Screw (1/4" - 20 x 1/4")	(4)	
6	Propeller (right hand pitch)	(1)	873327
7	Rod	(1)	
8	Elbow (1/4 - 18 N.P.T. x 1/2" o.d tube)	(1)	
9	Elbow (1/2 - 14 N.P.T. x 1/2" o.d tube)	(1)	
10	Needle Valve (1/4 - 18 P.T.F. SAE Short)	(1)	873409
11	Hose Clamp	(1)	
12	Tubing (1/2" o.d. x 8")	(1)	
13	Nipple (1/4 - 18 N.P.T. x 7/8")	(1)	
14	Handle	(1)	QN-97
15	Muffler	(1)	

● Items included but not shown.

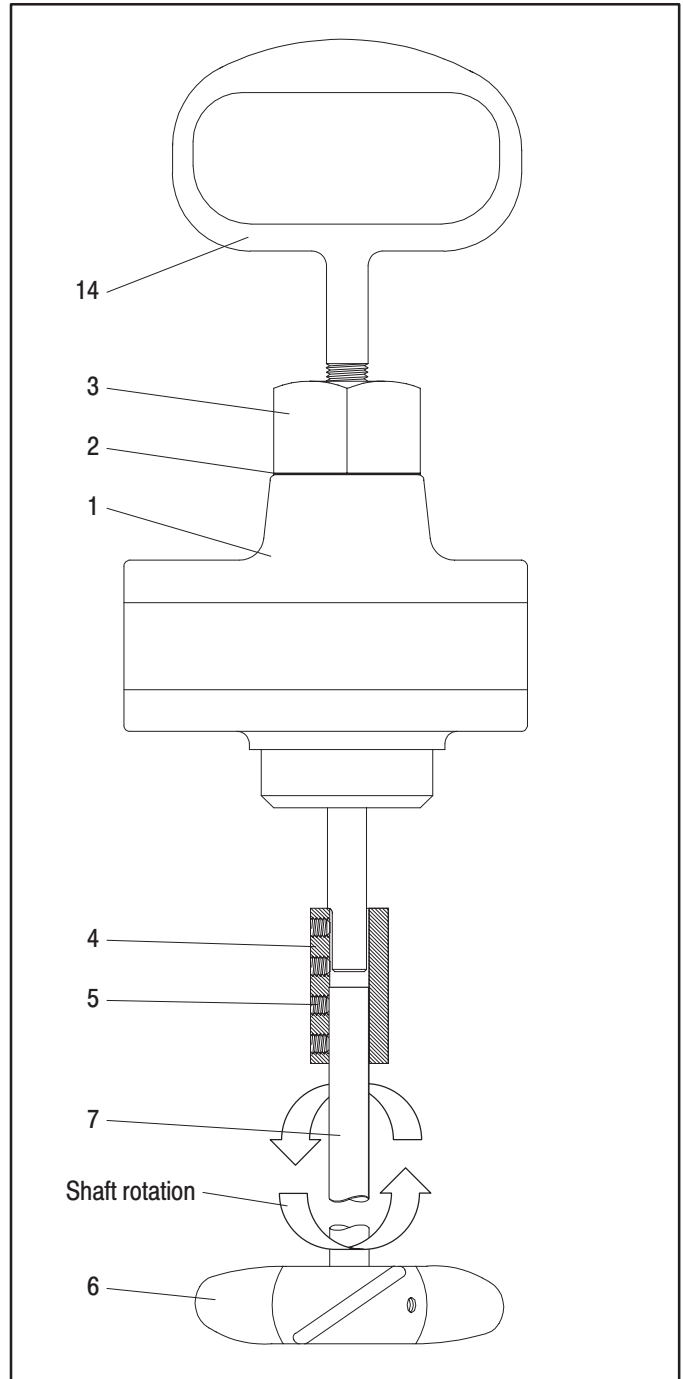

PN 876059



North American Office
 ITW Industrial Finishing
 195 Internationale Blvd
 Glendale Heights, IL 60139
 Tel. 630-237-5000 Fax 630-237-5011

International Office
 ITW Industrial Finishing
 Ringwood Road, Bournemouth
 Dorset, BH11 9LH, England
 Tel. 0 1202 571111 Fax 0 1202 593883